

70-B-51 - SPEEDLINE System Data Sheet - Version V1 (24-10-23)

SPEEDLINE 70mm 'C' Stud Partition @600mm Ctrs,
with BG Gyproc 12.5mm WallBoard each side

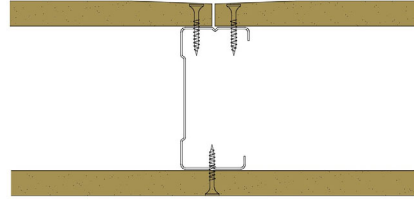

System Performance Breakdown

Fire Resistance:

BS476 Part 22:1987:

Test Ref:

Max Height:

Thickness:

Duty Grade: BS 5234: Part 2:1992:

Sound Insulation:

30/30 Minutes (Integrity/Insulation).

BRE Report P102396-1011A

Refer to Speedline Specification Clause

97 mm. (At Base Track, Excluding Finishes)

Medium - Annexes A-F

37 R_wdB, Date Tested or Assessed Against - 05/10/2006

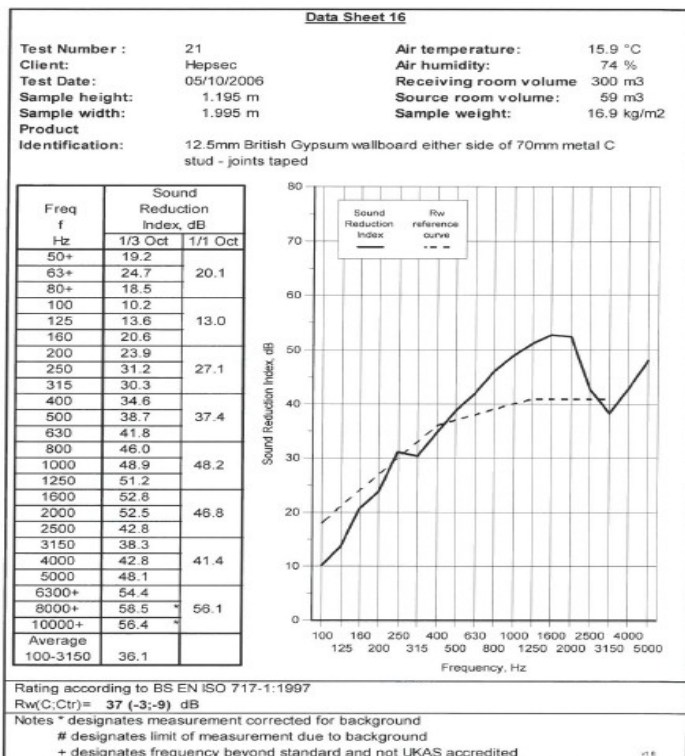

TESTED AT ONE OF THE UKAS ACCREDITED LABORATORIES BELOW

B.T.C (H-Ref on Graph)	
B.R.E	
AIRO	
S.R.L	